

PANDA SIMSELF MEMBRANES (SELF ADHESIVE)

SIMSELF MEMBRANES are self adhesive plastomeric and elastomeric type of membranes with APP (Atactic Polypropylene) & SBS (Styrene – Butadiene – Styrene) thermoplastic resin, used to enhance of the bitumen. For increasing physical strength of the membranes being used nonwoven polyester mat as a bearing and reinforcement system. After the removable film layer on one side is peeled,the membrane is ready to stick.

Section

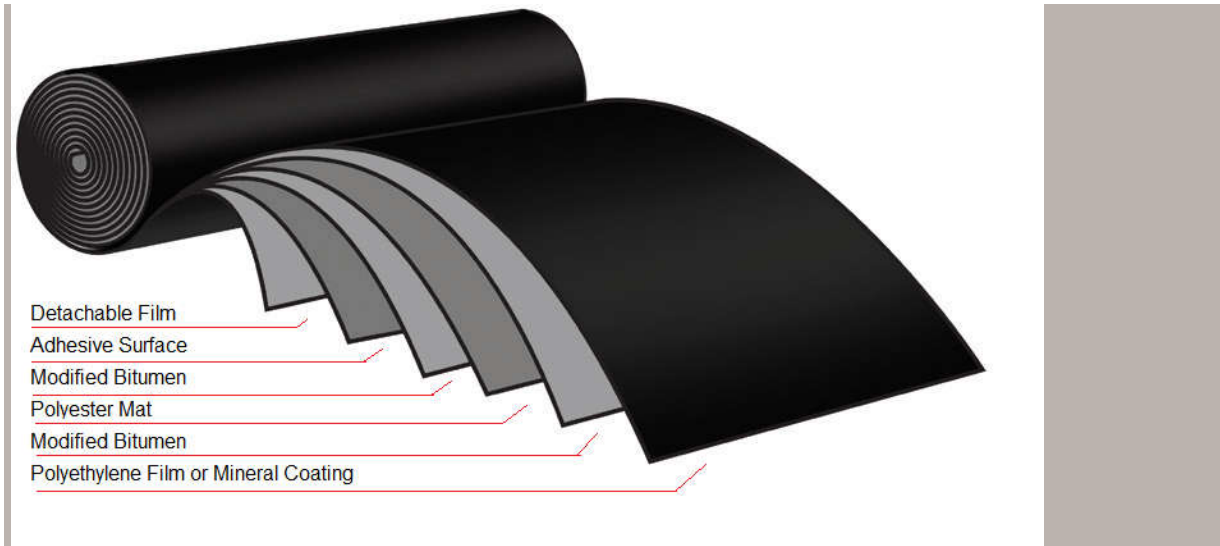

 **balcıođlu grup**

 **standart**
İZOLASYON MATERYALLERİ

MERKEZ: Fevzipaşa Mah. Kınalı Kavşađı Cad. No:123 ve 123/1 Silivri / İst.
ŞUBE : İkitelli OSB Keresteciler Sitesi 4.Blok No: 43 Başakşehir/İst.

☎: 444 88 78 - ☎: (212) 670 51 51

✉: bilgi@standartizolasyon.com 🌐: www.standartizolasyon.com

MARMARA KURUMLAR V.D. 7810157142 - Ticaret Sicil No. : 910 - SİLİVRİ

BALCIOĐLU GRUP STANDART İZOLASYON VE YAPI MATERYALLERİ SAN. TİC. A.Ş. - Mersis No : 0781015714200017

Roll



Balciođlu Grup Standart İzolasyon ve Yapı Materyalleri San. Tic. A.Ş.

Fevzipaşa Mah. Kınalı Kavşađı Cad. 282 Ada 2 parsel No: 123 -Silivri-İstanbul

Tel.: (0212) 735 35 95 Faks: (0212) 735 35 94

www.standartizolasyon.com

Properties

With its self adhesiveness, water tightness and resistance to structural movements, Simself Membranes bring practical solutions to many fine details. Thanks to its flexibility it is comfortably applied on curvilinear or skewed surfaces. Simself Membranes are produced in rolls of 1 meter width and 10 or 15 meters length. The membrane becomes ready to stick when the film layer is peeled. But to provide a good adhesion, the application surface should be dry and clean. On concrete surfaces, Standart bituminous primer should be applied prior to application and after the drying of the primer layer, SimSelf Membrane has to be stucked onto the already dry surface. Simself Membrane, which can be produced with mineral coating on one face, can be used as the uppermost layer material on covering.

Product Name.			SIMSELF SP1500	SIMSELF SP2000
Properties	Units	Test Methods		
Reinforcement (Carrier)			Polyester	Polyester
Thickness	mm	EN 1849-1	1,5	2
Weight	kg/m ²	-----	1,8 - 2,1	2,2 - 2,6
Roll Width	m	EN 1848-1	1	1
Roll Length	m	EN 1848-1	15	15
Visible Defects	-----	EN 1850-1	None	None
Heat Endurance (at least)	°C	EN 1110	110	110
Cold Flexibility (adhesive)	°C	EN 1109	>-20	>-20
Water impermeability	-	EN 1928	√	√
Tensile Strength Longitudinal (at least)	N/5cm	EN 12311-1	500	500
Tensile Strength Transverse(at least)	N/5cm	EN 12311-1	300	300

BALCIOĐLU GRUP STANDART İZOLASYON VE YAPI MATERYALLERİ SAN. TİC. A.Ş. - Mersis No : 0781015714200017

Longitudinal Elongation	%	EN 12311-1	30	30
Transverse Elongation	%	EN 12311-1	30	30
Resistance to static loading	kg	EN 12730	min 5	min 5
Tear Strength Value	N/50 mm	EN 12310-1	130(±%50)	130(±%50)
Value of Impact Resistance	mm	EN 12691	max 300	max 400
Directional Variation	mm	EN 1848-1	max 20	max 20
Reaction to Fire	-	EN 13501-1	E	E
Upper surface			PE Film	PE Film
Lower surface			Removable Film	Removable Film

Application Areas

Since Sinsself membranes can adhere to various surfaces such as wood, plastic, glass, mortar, concrete and more, they can be used on walls, parapets, chimney flashings, eaves, copings, gable walls, cracks in roof covering tiles, ship deck waterproofing, automotive industry, etc. especially where torch fire is risky or unsuitable to use. Sinsself membrane can easily be applied on fine details. Its self-adhesive lower surface can easily be applied on heat insulation boards (XPS, EPS, etc.) and materials non resistant to heat such as plastic and wood. In addition, on curvilinear and skewed roofs, its use is very easy and it takes the form of the application surface.

BALCIOĐLU GRUP STANDART İZOLASYON VE YAPI MATERYALLERİ SAN. TİC. A.Ş. - Mersis No : 0781015714200017

Storage and Protection

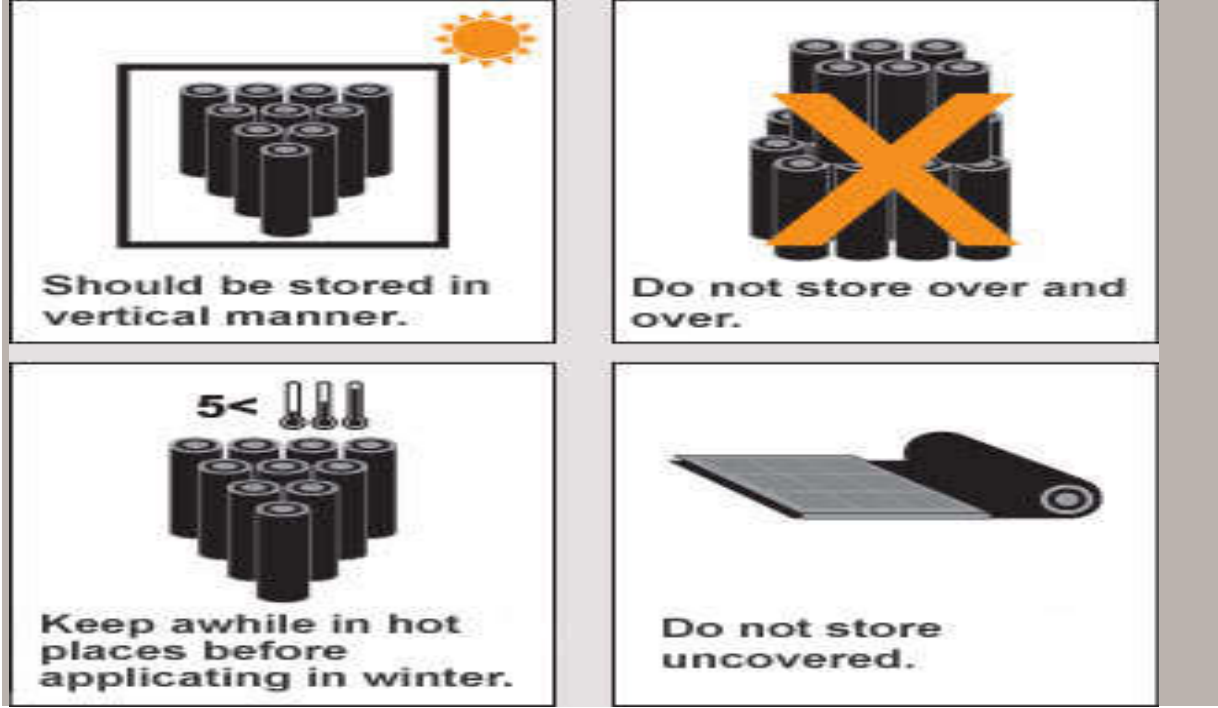

The rolls of bituminous membranes should be stored in vertical manner. Additionally during the transportation they should be placed vertically.

Simsself membranes should not be placed in overlapping manner preventing the heavy load on the rolls.

Membranes should be protected from freezing and sunlight (ultraviolet light).

They should be kept away from heating sources. They must be protected from sudden temperature changes.